





Highlighted area is the University's Public Property as defined by the Clery Act - All Public Property including thoroughfares, streets, sidewalks, and parking facilities that are within the campus or immediately adjacent to and accessible from the campus.



- Legend:**
-  Curb Cuts
 -  ADA Parking
 -  Automatic Doors
 - A-L** Parking lots
 -  Electric Car Charging Station

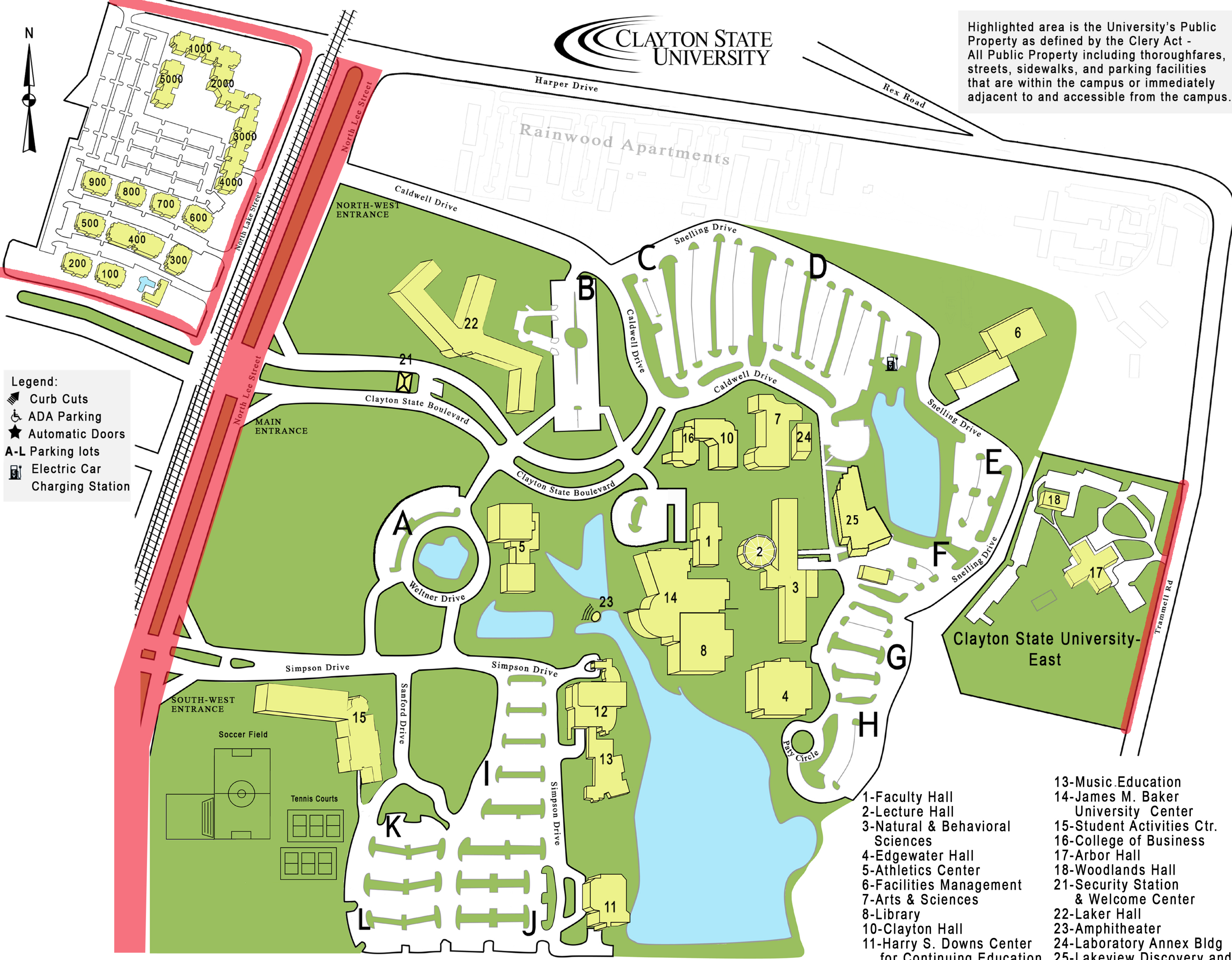

- | | |
|---|--|
| 1-Faculty Hall | 13-Music Education |
| 2-Lecture Hall | 14-James M. Baker University Center |
| 3-Natural & Behavioral Sciences | 15-Student Activities Ctr. |
| 4-Edgewater Hall | 16-College of Business |
| 5-Athletics Center | 17-Arbor Hall |
| 6-Facilities Management | 18-Woodlands Hall |
| 7-Arts & Sciences | 21-Security Station & Welcome Center |
| 8-Library | 22-Laker Hall |
| 10-Clayton Hall | 23-Amphitheater |
| 11-Harry S. Downs Center for Continuing Education and College of Health | 24-Laboratory Annex Bldg |
| 12-Spivey Hall | 25-Lakeview Discovery and Science Center |
| | 100-5000-Clayton Station |